



# COMMODORE 7600



## 1/2 HP MID DUTY

### Easy and Fast to Install

Commodore Bio Shield disposers feature Speed Master Mounting, an exclusive system that provides fast and economical installation.

### Corrosion Proof

Commodore Bio Shield Mid Duty model carries a lifetime warranty against failure due to corrosion.

### Permanent Magnet Motors

Commodore Bio Shield motors offer maximum torque instantly with the power to cut through potential jams.

### Removable Splash Guard

All Commodore Bio Shield models have a removable splash guard, ideal for easy cleaning and replacement.



**BIO SHIELD**  
(Antimicrobial)  
for **ODOR PROTECTION!**  
Disposers are treated with an antimicrobial agent molded inside providing protection against odor causing bacteria growth.

<b>HORSEPOWER</b>	1/2 HP
<b>MOTOR SPEED RPM</b>	2600 RPM
<b>VOLTAGE</b>	100v / 120v / 220-240v
<b>AMPS</b>	4.5 / 4.5 / 2.25
<b>CYCLES</b>	50/60
<b>MOTOR TYPE</b>	Permanent Magnet
<b>SPLASH GUARD</b>	EPDM Rubber
<b>DRAIN OUTLET</b>	Polycarbonate 940
<b>GRIND RING</b>	Stainless Steel
<b>SWIVEL IMPELLERS</b>	Stainless Steel
<b>BALANCED TURNTABLE</b>	Stainless Steel
<b>BALANCED ARMATURE SHAFT</b>	Stainless Steel
<b>HOPPER</b>	ABS
<b>DRAIN HOUSING</b>	Thermoset Polymer
<b>APPLIANCE PROTECTOR</b>	Manual Reset
<b>SINK FLANGE</b>	Polymide 66
<b>STOPPER</b>	Polypropylene
<b>BEARINGS</b>	Permanently Lubricated, Sleeve Type
<b>SOUND SHELL</b>	Full

### Dimensions

	<i>International</i>	<i>USA &amp; Canada</i>
<b>INDIVIDUAL SHIPPING WEIGHT</b>	4.8 KG	10.9 lb
<b>MASTER CARTON WEIGHT (4 UNITS)</b>	20.9 KG	49 lb
<b>MEASUREMENT A</b>	372 MM	14.6"
<b>MEASUREMENT B</b>	179 MM	7"
<b>MEASUREMENT C</b>	195 MM	7.7"
<b>MEASUREMENT D</b>	137 MM White Elbow / 140 MM Black Elbow	5.5"
<b>MEASUREMENT E</b>	70 MM White Elbow / 100 MM Black Elbow	3.9"
<b>LIFETIME CORROSION GUARANTEE</b>	Yes	Yes

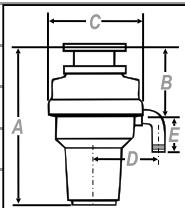

**The TORQUE MASTER Grinding System** is a combination of computer designed and balanced components working in unison to provide superior torque grind speed and long system life.

