

American Standard

ELITE

FOOD WASTE DISPOSER

1/3 HP

ASE-30

2400 RPM | 5-YEAR WARRANTY

- 3-Bolt Mount System for Easy Installation
- Snap Fast™ Tool for 1 Person Installation
- All Stainless Steel Grinding Components
- Compact Design
- High Torque Balanced Grinding System
- Antimicrobial Agent for Odor Protection
- Partial Sound Shell
- Removable Splash Guard
- Attached Power Cord
- Lifetime Corrosion Failure Warranty



BIO SHIELD® Antimicrobial
for **ODOR PROTECTION!**



TORQUE MASTER®
Balanced Grinding System:



HORSEPOWER	1/3 HP
MOTOR SPEED RPM	2400 RPM
VOLTAGE	120 VAC
AMPS	3 A
CYCLES	60 Hz
BEARINGS	Permanently Lubricated, Sleeve-Type
MOTOR TYPE	DC, Permanent Magnet
SPLASH GUARD	Removable
GRIND RING	Stainless Steel
SWIVEL IMPELLERS	Stamped Stainless Steel
BALANCED TURNTABLE	Stainless Steel
BALANCED ARMATURE SHAFT	Yes
HOPPER	Corrosion-Proof – Glass-Filled Polyester Nylon (PA66)
DRAIN HOUSING	Corrosion-Proof – Phenolic
APPLIANCE PROTECTOR	Manual Reset
SOUND-DAMPENING SHELL	Partial
HARDWARE INCLUDED	Stopper and Drain Elbow Kit
SINK FLANGE	Stainless Steel
MOUNT ASSEMBLY	3-Bolt
HOPPER CAPACITY	29 oz.
POWER CORD LENGTH	34"
UNIT WEIGHT	8.4 lbs.

Dimensions:

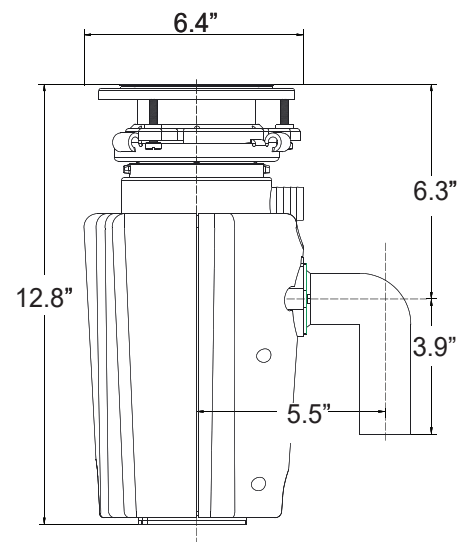

FOR MORE INFORMATION CALL: 888-856-6322 (Toll-Free)

M-F 8:00am-5:00pm PST English & Spanish

SS-ASE30-231

American Standard

ELITE

FOOD WASTE DISPOSER

1/2 HP

ASE-50

2600 RPM | 6-YEAR WARRANTY

- 3-Bolt Mount System for Easy Installation
- Snap Fast™ Tool for 1 Person Installation
- All Stainless Steel Grinding Components
- Compact Design
- High Torque Balanced Grinding System
- Antimicrobial Agent for Odor Protection
- Partial Sound Insulated Shell
- Removable Splash Guard
- Attached Power Cord
- Lifetime Corrosion Failure Warranty



BIO SHIELD® Antimicrobial
for **ODOR PROTECTION!**



TORQUE MASTER®
Balanced Grinding System:



HORSEPOWER	1/2 HP
MOTOR SPEED RPM	2600 RPM
VOLTAGE	120 VAC
AMPS	4.5 A
CYCLES	60 Hz
BEARINGS	Permanently Lubricated, Sleeve-Type
MOTOR TYPE	DC, Permanent Magnet
SPLASH GUARD	Removable
GRIND RING	Stainless Steel
SWIVEL IMPELLERS	Stamped Stainless Steel
BALANCED TURNTABLE	Stainless Steel
BALANCED ARMATURE SHAFT	Yes
HOPPER	Corrosion-Proof – Glass-Filled Polyester Nylon (PA66)
DRAIN HOUSING	Corrosion-Proof – Phenolic
APPLIANCE PROTECTOR	Manual Reset
SOUND-DAMPENING SHELL	Partial - Insulated
HARDWARE INCLUDED	Stopper and Drain Elbow Kit
SINK FLANGE	Stainless Steel
MOUNT ASSEMBLY	3-Bolt
HOPPER CAPACITY	29 oz.
POWER CORD LENGTH	34"
UNIT WEIGHT	8.9 lbs.

Dimensions:

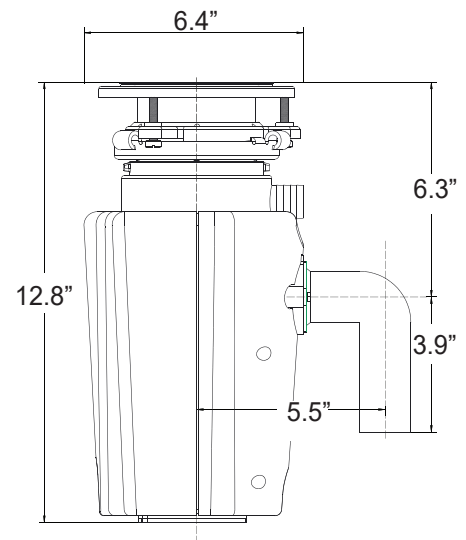

FOR MORE INFORMATION CALL: 888-856-6322 (Toll-Free)

M-F 8:00am-5:00pm PST English & Spanish

American Standard

ELITE

FOOD WASTE DISPOSER

1/2 HP

ASE-70

2600 RPM | 6-YEAR WARRANTY

- 3-Bolt Mount System for Easy Installation
- Snap Fast™ Tool for 1 Person Installation
- All Stainless Steel Grinding Components
- High Torque Balanced Grinding System
- Antimicrobial Agent for Odor Protection
- Fully Insulated Sound Shell
- Removable Splash Guard
- Attached Power Cord
- Lifetime Corrosion Failure Warranty



BIO SHIELD® Antimicrobial
for **ODOR PROTECTION!**



TORQUE MASTER®
Balanced Grinding System:



HORSEPOWER	1/2 HP
MOTOR SPEED RPM	2600 RPM
VOLTAGE	120 VAC
AMPS	4.5 A
CYCLES	60 Hz
BEARINGS	Permanently Lubricated, Sleeve-Type
MOTOR TYPE	DC, Permanent Magnet
SPLASH GUARD	Removable
GRIND RING	Stainless Steel
SWIVEL IMPELLERS	Stamped Stainless Steel
BALANCED TURNTABLE	Stainless Steel
BALANCED ARMATURE SHAFT	Yes
HOPPER	Corrosion-Proof – Glass-Filled Polyester Nylon (PA66)
DRAIN HOUSING	Corrosion-Proof – Phenolic
APPLIANCE PROTECTOR	Manual Reset
SOUND-DAMPENING SHELL	Full - Insulated
HARDWARE INCLUDED	Stopper and Drain Elbow Kit
SINK FLANGE	Stainless Steel
MOUNT ASSEMBLY	3-Bolt
HOPPER CAPACITY	29 oz.
POWER CORD LENGTH	34"
UNIT WEIGHT	9.8 lbs.

Dimensions:

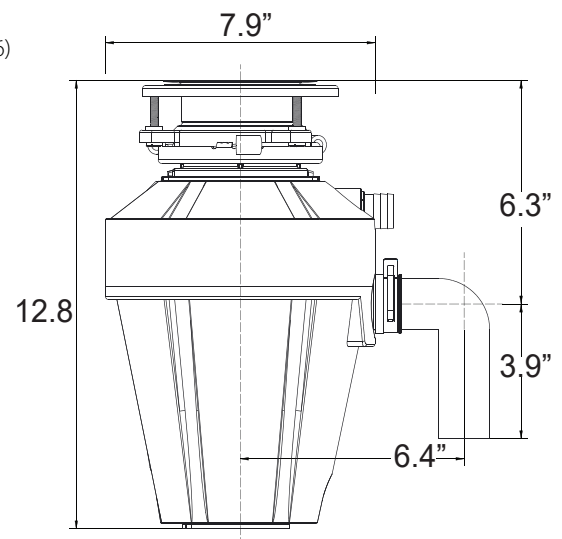

FOR MORE INFORMATION CALL: 888-856-6322 (Toll-Free)

M-F 8:00am-5:00pm PST English & Spanish

American Standard

ELITE

FOOD WASTE DISPOSER

3/4 HP

ASE-780-SL

2700 RPM | 10-YEAR WARRANTY

- 3-Bolt Mount System for Easy Installation
- Snap Fast™ Tool for 1 Person Installation
- All Stainless Steel Grinding Components
- High Torque Balanced Grinding System
- Antimicrobial Agent for Odor Protection
- Fully Insulated Sound Shell
- Removable Splash Guard
- Attached Power Cord
- Lifetime Corrosion Failure Warranty
- Silver Guard® Magnetic Disposer Protection



BIO SHIELD® Antimicrobial
for **ODOR PROTECTION!**



TORQUE MASTER®
Balanced Grinding System:



HORSEPOWER	3/4 HP
MOTOR SPEED RPM	2700 RPM
VOLTAGE	120 VAC
AMPS	6 A
CYCLES	60 Hz
BEARINGS	Permanently Lubricated, Sleeve-Type
MOTOR TYPE	DC, Permanent Magnet
SPLASH GUARD	Removable
GRIND RING	Stainless Steel
SWIVEL IMPELLERS	Cast Stainless Steel
BALANCED TURNTABLE	Stainless Steel
BALANCED ARMATURE SHAFT	Yes
HOPPER	Corrosion-Proof – Glass-Filled Polyester Nylon (PA66)
DRAIN HOUSING	Corrosion-Proof – Phenolic
APPLIANCE PROTECTOR	Manual Reset
SOUND-DAMPENING SHELL	Full - Insulated
HARDWARE INCLUDED	Stopper and Drain Elbow Kit
SINK FLANGE	Stainless Steel
MOUNT ASSEMBLY	3-Bolt
HOPPER CAPACITY	36 oz.
POWER CORD LENGTH	34"
UNIT WEIGHT	12 lbs.

Dimensions:

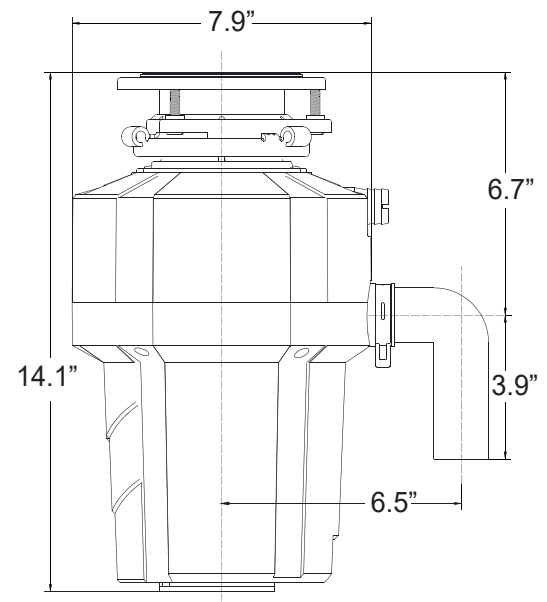

FOR MORE INFORMATION CALL: 888-856-6322 (Toll-Free)

M-F 8:00am-5:00pm PST English & Spanish

American Standard

ELITE

FOOD WASTE DISPOSER

3/4 HP

ASE-90-SL

2700 RPM | 10-YEAR WARRANTY

- Compact Design
- 3-Bolt Mount System for Easy Installation
- All Stainless Steel Grinding Components
- High Torque Balanced Grinding System
- Antimicrobial Agent for Odor Protection
- Removable Splash Guard
- Attached Power Cord
- Lifetime Corrosion Failure Warranty



BIO SHIELD® Antimicrobial
for **ODOR PROTECTION!**



TORQUE MASTER®
Balanced Grinding System:



HORSEPOWER	3/4 HP
MOTOR SPEED RPM	2700 RPM
VOLTAGE	120 VAC
AMPS	6 A
CYCLES	60 Hz
BEARINGS	Permanently Lubricated, Sleeve-Type
MOTOR TYPE	DC, Permanent Magnet
SPLASH GUARD	Removable
GRIND RING	Stainless Steel
SWIVEL IMPELLERS	Cast Stainless Steel
BALANCED TURNTABLE	Stainless Steel
BALANCED ARMATURE SHAFT	Yes
HOPPER	Corrosion Proof- Glass-Filled Polyester Nylon (PA66)
DRAIN HOUSING	Corrosion Proof - Phenolic
APPLIANCE PROTECTOR	Manual Reset
SOUND-DAMPENING SHELL	Full - Insulated
HARDWARE INCLUDED	Stopper and Drain Elbow Kit
SINK FLANGE	Stainless Steel
MOUNT ASSEMBLY	3-Bolt
HOPPER CAPACITY	36 oz.
POWER CORD LENGTH	34"
UNIT WEIGHT	12 lbs.

Dimensions:

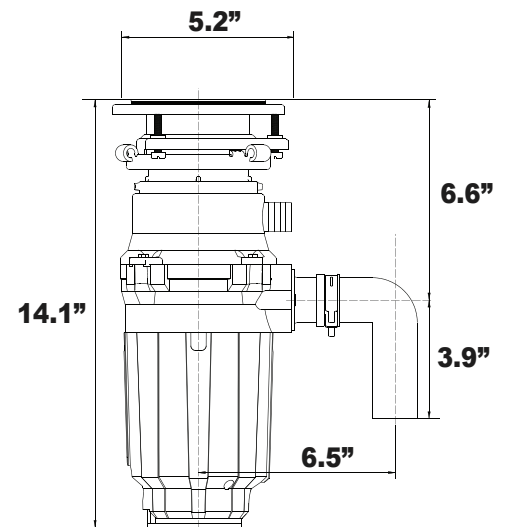

FOR MORE INFORMATION CALL: 888-856-6322 (Toll-Free)

M-F 8:00am-5:00pm PST English & Spanish

American Standard

ELITE

FOOD WASTE DISPOSER

1-1/4 HP

Highest Torque
ASE-125-HT

2800 RPM | 12-YEAR WARRANTY

- 3-Bolt Mount System for Easy Installation
- Snap Fast™ Tool for 1 Person Installation
- All Stainless Steel Grinding Components
- High Torque Balanced Grinding System
- Antimicrobial Agent for Odor Protection
- Fully Insulated Sound Shell
- Removable Splash Guard
- Attached Power Cord
- Lifetime Corrosion Failure Warranty
- Silver Guard® Magnetic Disposer Protection
- Hush-Tek™ Sound Suppression



BIO SHIELD®
Antimicrobial
for odor protection



TORQUE MASTER®
Balanced Grinding
System



Hush-Tek™ Sound
Suppression -
quieter grinding and
operation



HORSEPOWER	1-1/4 HP
MOTOR SPEED RPM	2800 RPM
VOLTAGE	120 VAC
AMPS	7.5 A
CYCLES	60 Hz
BEARINGS	Permanently Lubricated, Sleeve-Type
MOTOR TYPE	DC, Permanent Magnet
SPLASH GUARD	Removable
GRIND RING	Stainless Steel
SWIVEL IMPELLERS	Cast Stainless Steel
BALANCED TURNTABLE	Stainless Steel
BALANCED ARMATURE SHAFT	Yes
HOPPER	Corrosion-Proof – Phenolic
DRAIN HOUSING	Corrosion-Proof – Glass-Filled Polyester Nylon (PA66)
APPLIANCE PROTECTOR	Manual Reset
SOUND-DAMPENING SHELL	Advanced Sound Suppression
HARDWARE INCLUDED	Stopper and Drain Elbow Kit
SINK FLANGE	Stainless Steel
MOUNT ASSEMBLY	3-Bolt
HOPPER CAPACITY	36 oz.
POWER CORD LENGTH	34"
UNIT WEIGHT	13.9 lbs.

Dimensions:

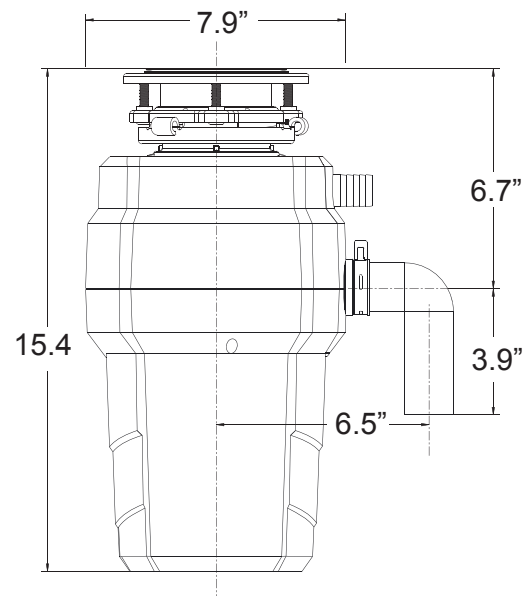

FOR MORE INFORMATION CALL: 888-856-6322 (Toll-Free)

M-F 8:00am-5:00pm PST English & Spanish